

By Order of GM OPEL German we offer for Sale:

Complete EISENMANN Painting Line for Sheet Metal and Car Body Components

Line for Painting/Corrosion Protection of Parts up to 2.730 x 2.575 x 1.300 mm

Year of Manufacture: 1991 / was in Use until End of 2010

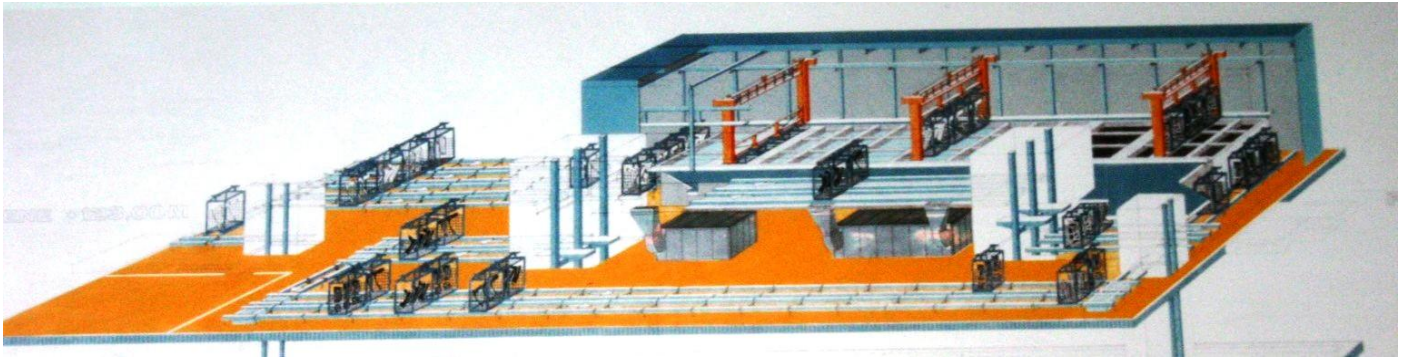

Capacity of the Line:

- | | |
|---------------------------------|---|
| - Max part size: | 2.730 x 2.575 x 1.300 mm |
| - Max weight per charge: | 760 kg |
| - Max surface per charge: | 36 square meters |
| - Max part surface per Day: | 39.000 square meters |
| - Effective running per Day: | 21 hours |
| - Cycle Time for Painting-Line: | 3,5 Minutes |
| - Cycle Time for Drying-Line: | 2,33 Minutes |
| - Space required: | 5 levels of ca. 90 x 40 meters each
or ca. 10.000 square meters on one level |

Including Zones for following Processes:

- Degreasing
- Washing
- Activating
- Phosphating
- Washing
- Passivation
- Immersion-Painting
- Washing from remaining Paint
- Evaporation
- Drying (185 Deg C)
- Cooling

The Paint Line is installed on 5 levels due to ground floor restrictions when built. There are conveyor and lifting systems connecting all 5 levels. Line can be arranged also on less levels or completely on one level only.

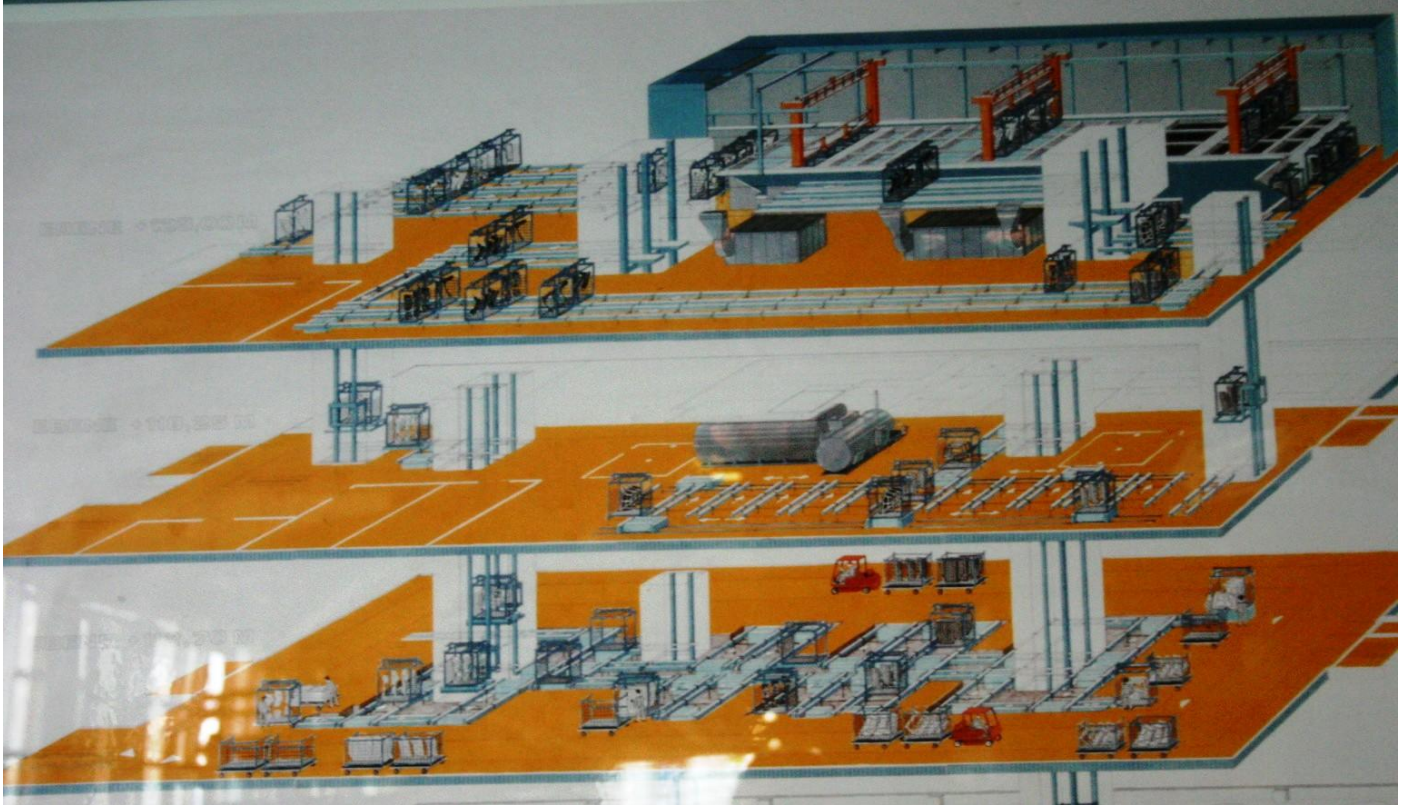

Paint Shop Level 3 – 5

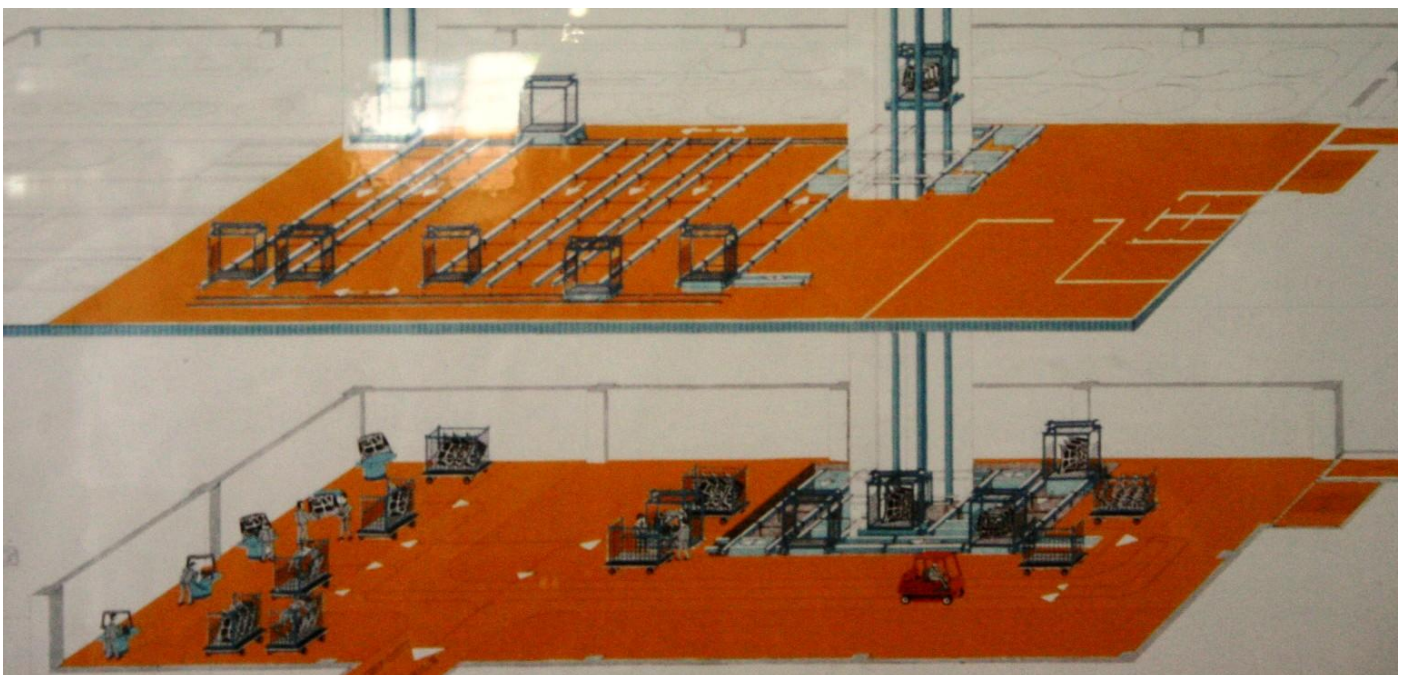

Paint Shop Level 1 – 2



Paint Shop Building



EISENMANN Immersion-Painting (5th Level)



Installation (Paint Unit)



Drying / Coolant Zone (5th Level)



Lift (4th Level)



Conveyor System (3rd Level)

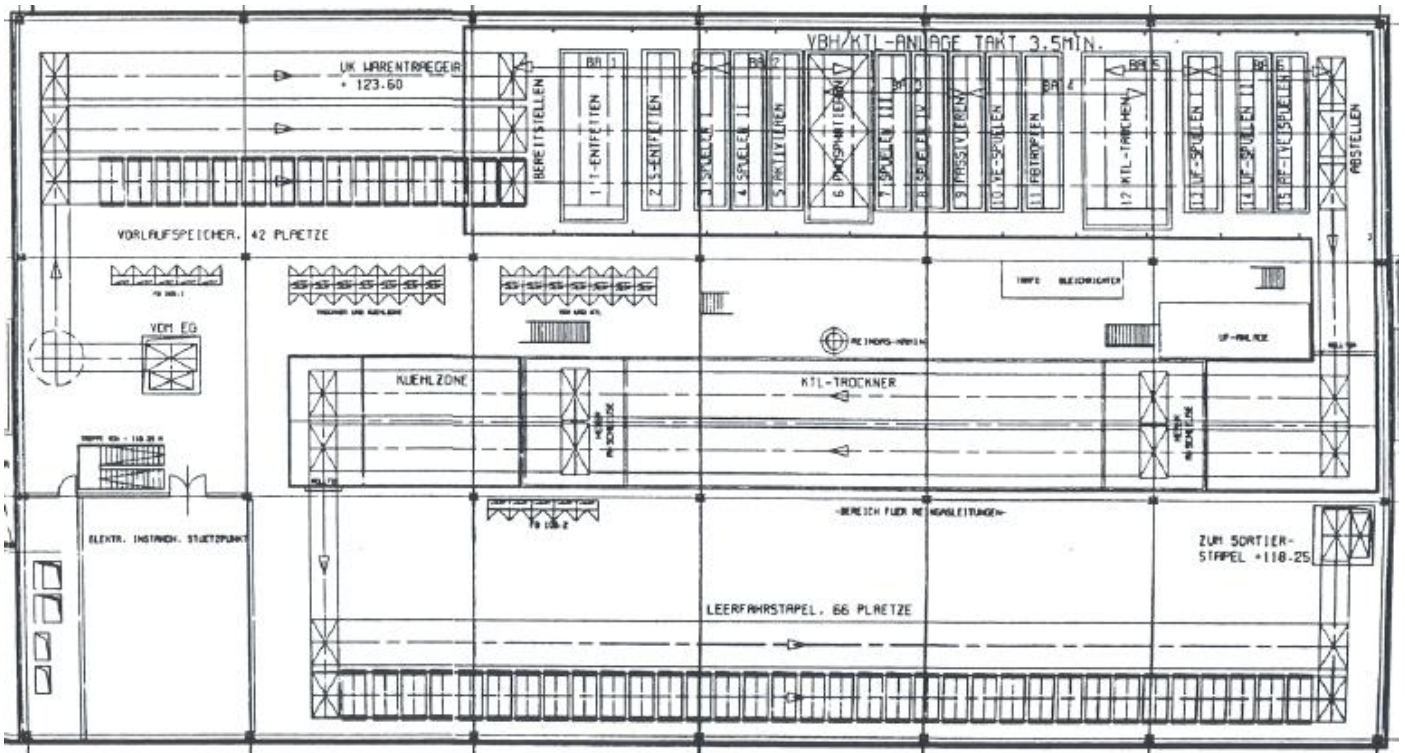

5th Level: Immersion Painting Line and Drying/Coolant Line

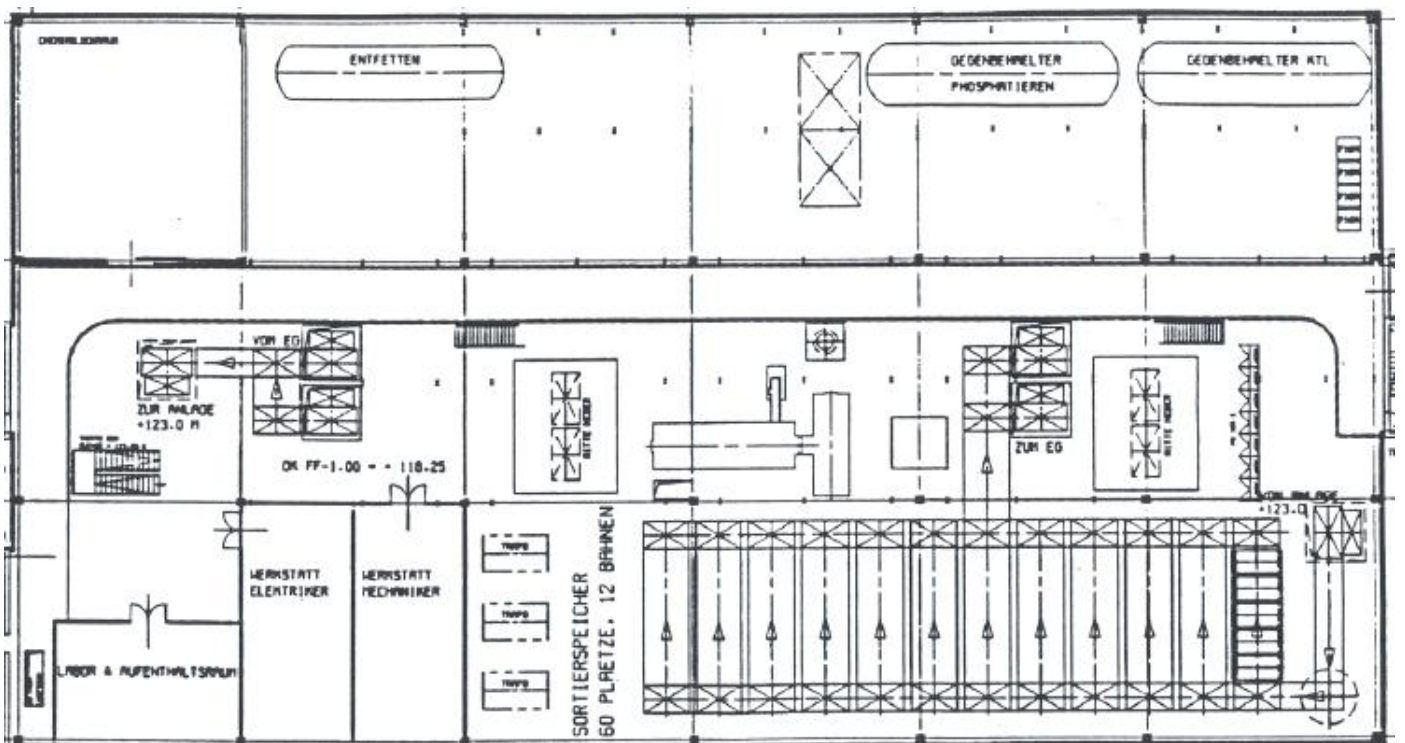

4th Level: Degreasing and Washing

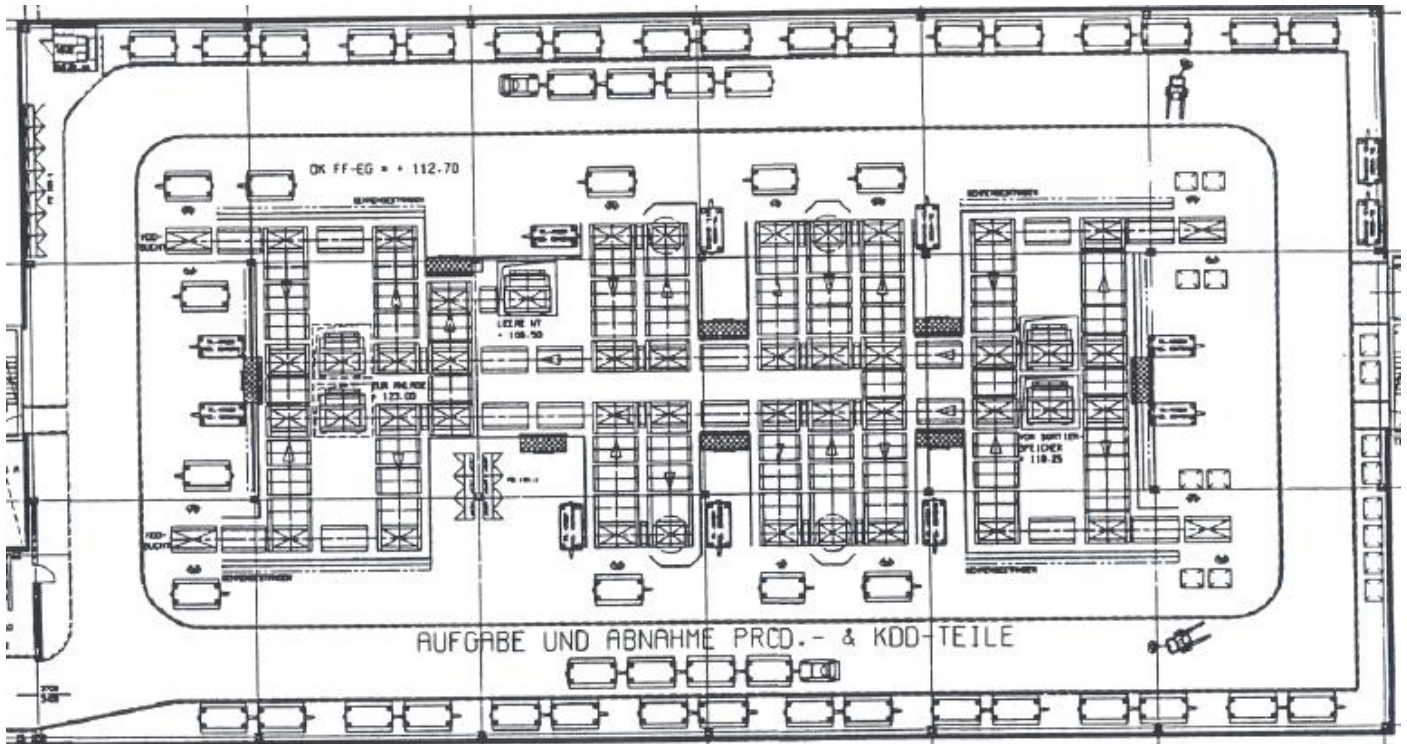

3rd Level: Loading and Unloading of Parts (this floor space is not necessarily required completely)

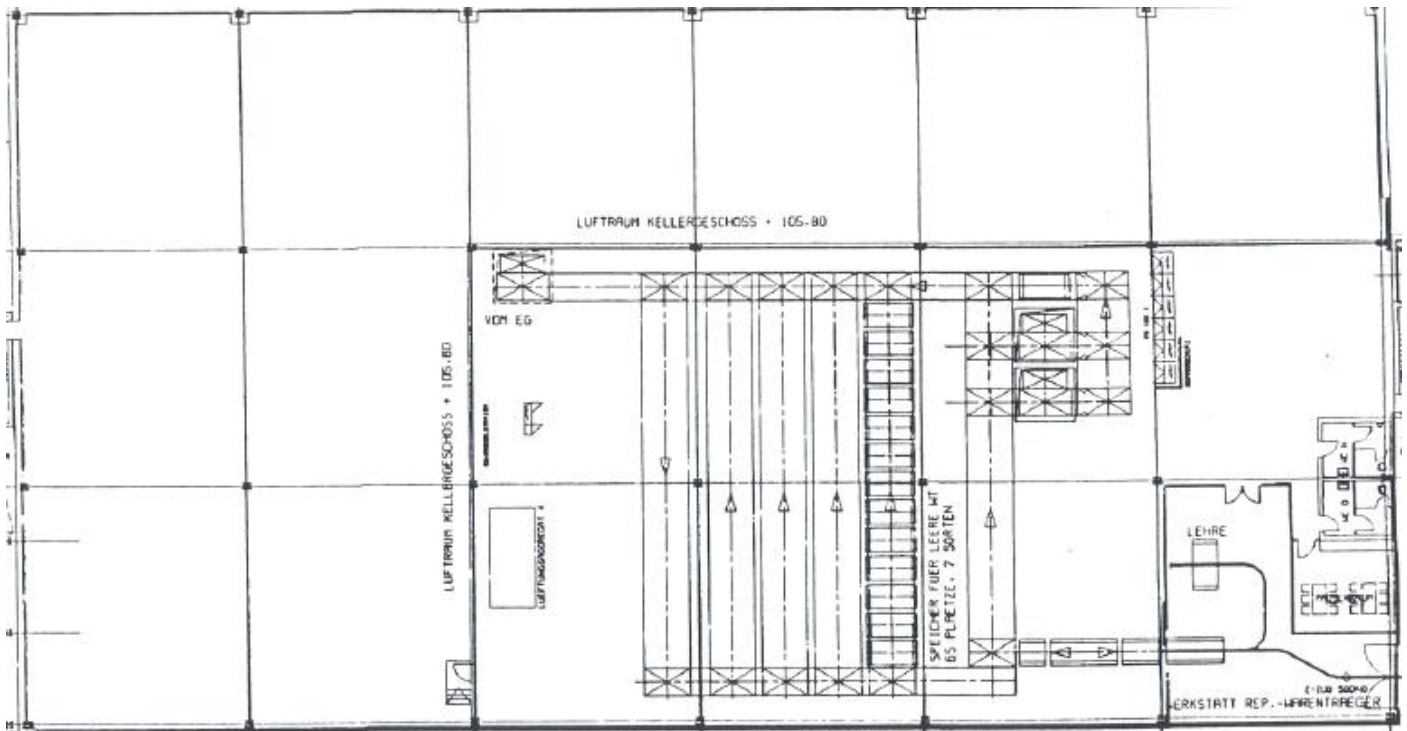

2nd Level: Sorting Area (not necessarily required)

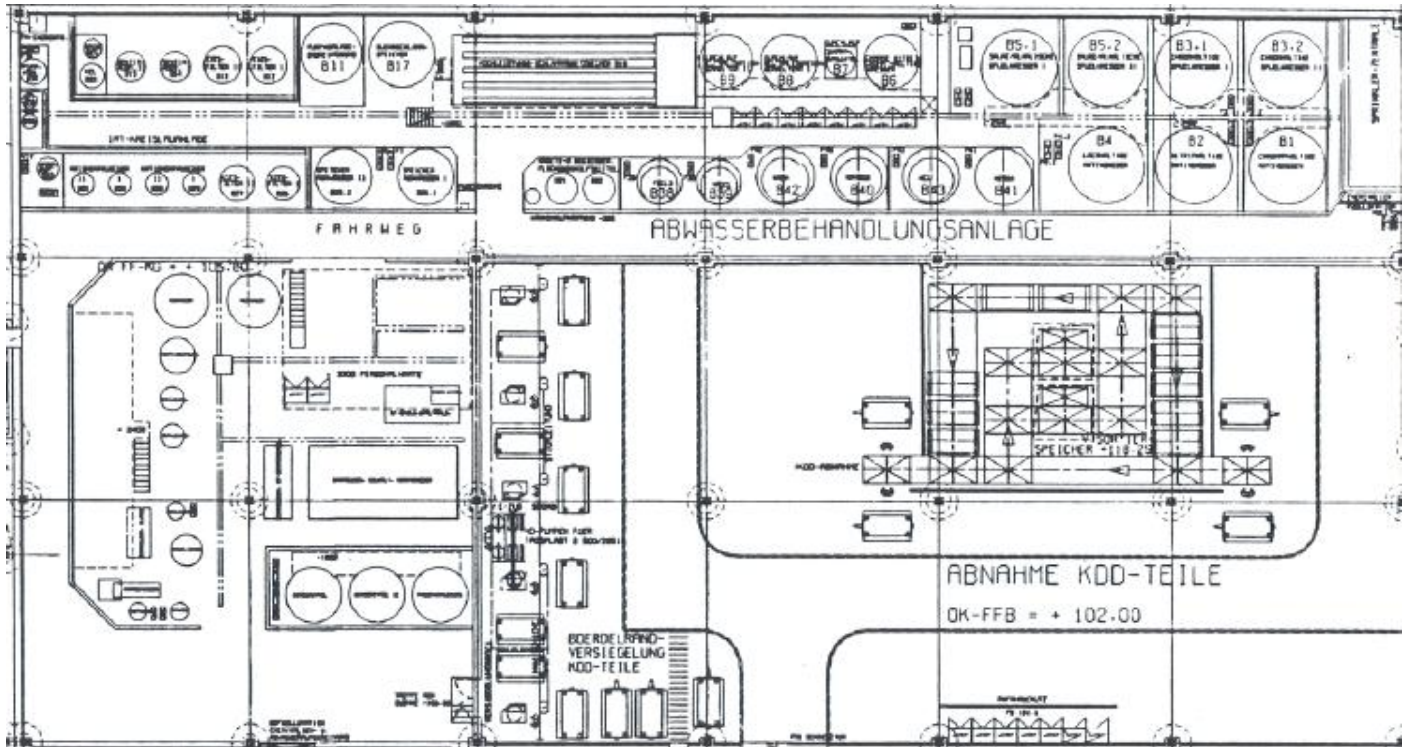

Ground Level: fluid Media Treatment



Fluid Media Treatment

General Information:

- Inspections by appointment only! Location: OPEL Bochum / Germany (next Airport: Duesseldorf)
- All Equipment becomes offered "AS IS, WHERE IS" and subject to prior Sale!
- Although Information has been given from sources deemed reliable, MAYNARDS make no warranty or guarantee, expressed or implied, as to the accuracy of the information contained herein.
- All offers are subject to approval by the Seller and subject to acceptance of Sellers OFFER TO PURCHASE.
- This Sale is based on the Terms & Conditions of GM OPEL and MAYNARDS

For further Information and Photos or an Inspection Appointment please contact:

Andreas Matuszczak, andreas@maynards.com, Tel +49 174 3210116